



# GLV

---

## SERIES



## PRESSURE

*RELIEF VALVES*



Management System  
ISO 9001:2015



www.tuv.com  
ID: 9105022030

# GLV SERIES

## TABLE OF CONTENTS

### ST. STEEL VERSION

Introduction	Page	1
Type A DN15	Page	2 - 3
Type B DN25	Page	4 - 5
Type C DN40	Page	6 - 7
Type D DN50	Page	8 - 9
Type F	Page	11

### COPPER ALLOY VERSION

Type E	Page	10
--------	------	----

### PLASTIC VERSION

Introduction	Page	13
Type A DN15	Page	14 - 15
Type B DN25	Page	16 - 17
Type C DN40	Page	18 - 19
Type D DN50	Page	20 - 21

**Relief Valves GLV-Series** are spring loaded pressure relieving devices, suitable for discharge of incompressible fluids. GLV-series relief valves are used to protect personnel, equipment and environment by preventing excessive pressure accumulation.

Coi Technology offers a large range of screwed and flanged valves in a variety of sizes, materials and options. The valves are of a full nozzle type and available in Steel or plastic versions.

#### Application

- Chemical plants
- Petrochemical plants
- Dosing systems
- Injections skids
- Metering pumps
- Water treatment and desalination plants
- Cryogenic plants (liquefied gases)

#### Materials

AISI 316L, Inconel, Alloy 20, Hastelloy, Titanium, Duplex, Super duplex, Monel, other exotic materials are available.

#### Design

- Construction: Angle-type
- Seat sealing type: PTFE, PEEK, Metal to Metal, Viton, Kalrez, EPDM
- Connections: Screwed and flanged (ANSI / DIN)
- Connections types: NPT, GAS/BSPP
- Flange ratings: ASME 150 ÷ 2500 / PN16 ÷ PN 400
- Sizes: 1/2" ÷ 2" / DN 15 ÷ DN 50
- Orifices: 6, 8, 10, 14, 20, 25, 30 mm
- Characteristic: Full lift
- Overpressure: 10%
- Blowdown: 15%
- Discharge coeff. Kd: 0.7
- Temperature range: - 196°C + 350°C
- Set pressure range: 0.5 ÷ 800 barg
- Design standard: UNI EN ISO 4126-1

#### Approvals

- CE marking according to the dir. 2014/68/EU
- 2014/34/EU (ATEX)
- EAC ( EurAsian Conformity mark (EAC, Russian: Евразийское соответствие)

# TYPE "A"

## CHARACTERISTICS

Orifice $\varnothing$ / mm	6	8	10
Discharge area / cm <sup>2</sup>	0.28	0.504	0.785
Pressure range / bar	0.5 ÷ 690	0.5 ÷ 250	0.5 ÷ 110

## INLET CONNECTIONS

Threaded	1/2" - 3/4"	NPT / GAS	
Flanged / ASME	1/2" - 3/4"	150# ÷ 2500#	RF / RTJ
Flanged / DIN	DN15/DN20	PN16 ÷ PN400	

## OUTLET CONNECTIONS

Threaded	1/2" - 3/4"	NPT / GAS	
Flanged / ASME	1/2" - 3/4"	150# ÷ 600#	RF
Flanged / DIN	DN15/DN20	PN16 ÷ PN40	

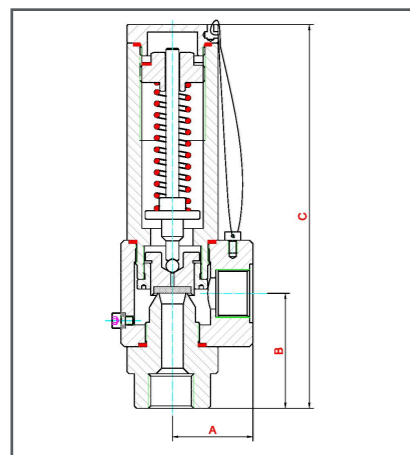

CONNECTIONS	THREADED	A	B	C	WEIGHT
Type		mm	mm	mm	kg
1/2" x 1/2"	NPT-F / GAS-F	37	53	177	2,5
3/4" x 3/4"	NPT-F / GAS-F	37	53	177	2,5

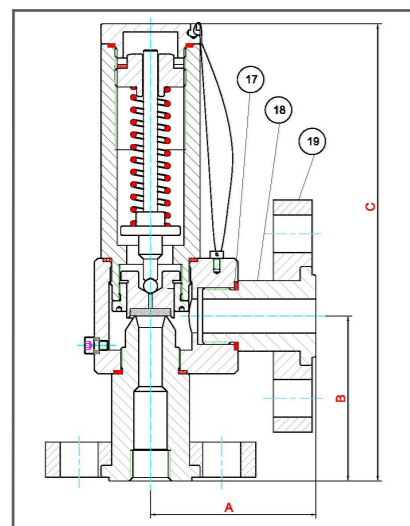

CONNECTIONS	FLANGED	A	B	C	WEIGHT
Type		mm	mm	mm	kg
1/2" x 1/2"	ASME 150÷300 x 150÷300	70	70	194	4,0
	ASME 600 x 600	85	85	209	4,0
	ASME 900÷1500 x 150÷600	85	100	224	6,0
	ASME 2500 x 150÷600	85	100	224	7,0
3/4" x 3/4"	ASME 150÷600 x 150÷600	85	85	209	4,5
	ASME 900÷1500 x 150÷600	100	100	224	6,5
	ASME 2500 x 150÷600	100	105	229	7,5
DN15 x DN15	PN 16÷40 x 16÷40	70	70	194	4,0
	PN 63÷320 x 16÷40	85	100	224	6,0
	PN 400 x 16÷40	85	100	224	7,0
DN20 x DN20	PN 16÷40 x 16÷40	85	85	209	4,5
	PN 63÷320 x 16÷40	100	100	224	6,5
	PN 400 x 16÷40	100	105	229	7,5

## MATERIALS

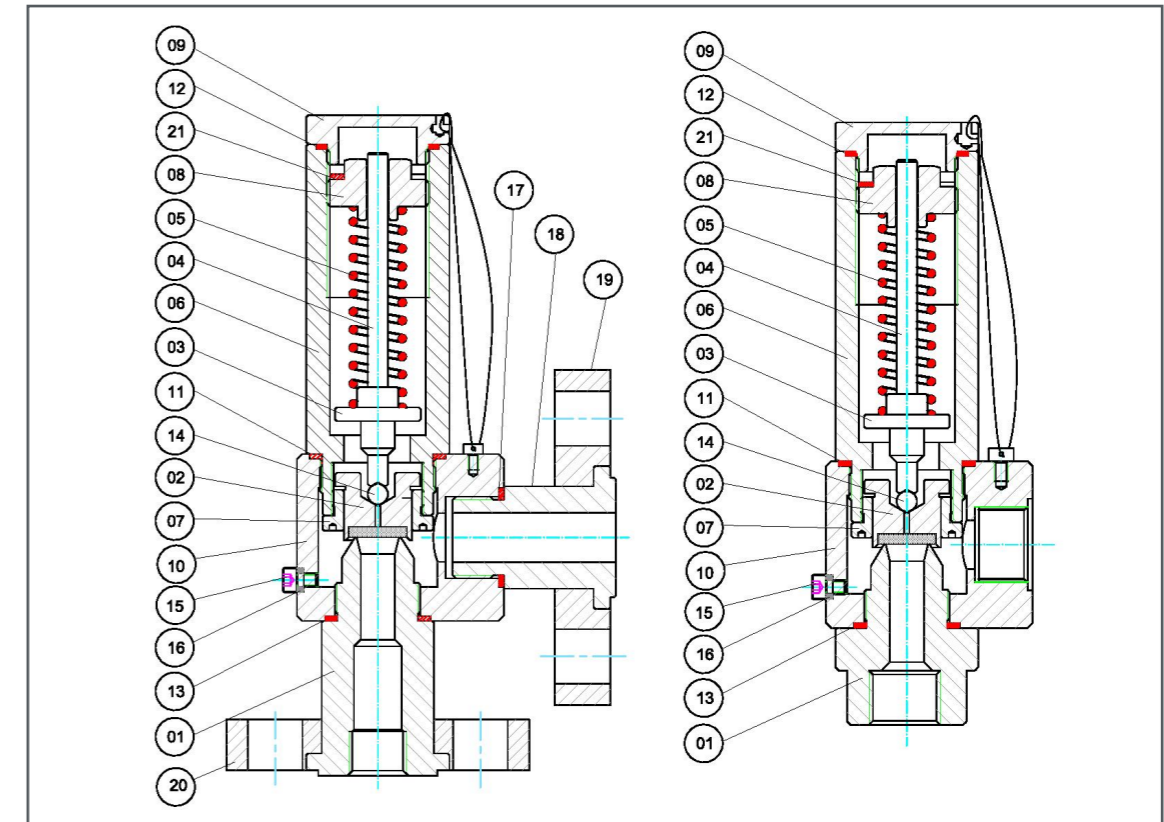

PART NAME		MATERIAL CODE			
		011	072	012	095
01	NOZZLE	AISI 316L	AISI 316L	AISI 316L	AISI 316L
02	DISC	AISI 316L/PTFE	AISI 316L/PTFE	AISI 316L/PEEK	AISI 316L/PEEK
03	LOWER WASHER	AISI 316L	AISI 316L	AISI 316L	AISI 316L
04	STEM	AISI 316L	AISI 316L	AISI 316L	AISI 316L
05	SPRING	ALL. STEEL	ALL. STEEL	ALL. STEEL	ALL. STEEL
06	BONNET	AISI 316L	AISI 316L	AISI 316L	AISI 316L
07	GUIDE	AISI 316L	AISI 316L	AISI 316L	AISI 316L
08	SET SCREW	AISI 316L	AISI 316L	AISI 316L	AISI 316L
09	CAP	AISI 316L	AISI 316L	AISI 316L	AISI 316L
10	BODY	AISI 316L	AISI 316L	AISI 316L	AISI 316L
11	GASKET	PTFE	PTFE	PTFE	PTFE
12	GASKET	PTFE	PTFE	PTFE	PTFE
13	GASKET	PTFE	PTFE	PTFE	PTFE
14	BALL	AISI 316	AISI 316	AISI 316	AISI 316
15	SCREW	AISI 316L	AISI 316L	AISI 316L	AISI 316L
16	GASKET	PTFE	PTFE	PTFE	PTFE
17	GASKET	PTFE	PTFE	PTFE	PTFE
18	NIPPLE	AISI 316L	AISI 316L	AISI 316L	AISI 316L
19	OUTLET FLANGE	CARBON STEEL	AISI 316	CARBON STEEL	AISI 316
20	INLET FLANGE	CARBON STEEL	AISI 316	CARBON STEEL	AISI 316
21	SEEGER	AISI 316L	AISI 316L	AISI 316L	AISI 316L

# TYPE "B"

## CHARACTERISTICS

Orifice $\varnothing$ / mm	6	8	10	14
Discharge area / cm <sup>2</sup>	0.28	0.504	0.785	1.54
Pressure range / bar	0.5 ÷ 690	0.5 ÷ 410	0.5 ÷ 130	0.5 ÷ 65

## INLET CONNECTIONS

Threaded	1/2" - 3/4" - 1"	NPT / GAS	
Flanged / ASME	1/2" - 3/4" - 1"	150# ÷ 2500#	RF / RTJ
Flanged / DIN	DN15/DN25	PN16 ÷ PN400	

## OUTLET CONNECTIONS

Threaded	1"	NPT / GAS	
Flanged / ASME	1"	150# ÷ 600#	RF
Flanged / DIN	DN25	PN16 ÷ PN40	

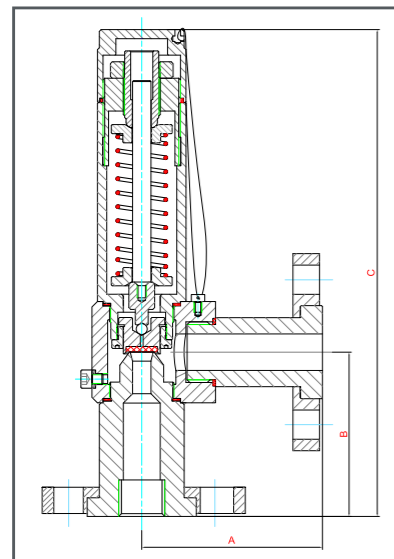
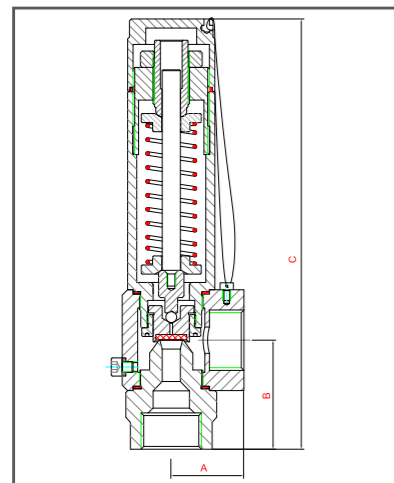

CONNECTIONS	THREADED	A	B	C	WEIGHT
Type		mm	mm	mm	kg
1/2" x 1"	NPT-F / GAS-F	37/42*	60	237	3,5
3/4" x 1"	NPT-F / GAS-F	37/42*	60	237	3,5
1" x 1"	NPT-F / GAS-F	37/42*	60	237	3,5

\* Ori ice. 10/14 mm

CONNECTIONS	FLANGED	A	B	C	WEIGHT
Type		mm	mm	mm	kg
1/2" x 1"	ASME 150÷600 x 150÷600	98	90	267	5,5
	ASME 900÷1500 x 150÷600	98	115	292	7,0
	ASME 2500 x 150÷600	98	115	292	8,0
3/4" x 1"	ASME 150÷600 x 150÷600	98	90	267	5,5
	ASME 900÷1500 x 150÷600	98	115	292	7,0
	ASME 2500 x 150÷600	98	115	292	8,0
1" x 1"	ASME 150÷600 x 150÷600	98	90	267	5,5
	ASME 900÷1500 x 150÷600	98	115	292	7,0
	ASME 2500 x 150÷600	98	115	292	8,0
DN15 x DN25	PN 16÷40 x 16÷40	98	90	267	5,5
	PN 63÷320 x 16÷40	98	115	292	7,0
	PN 400 x 16÷40	98	115	292	8,0
DN20 x DN25	PN 16÷40 x 16÷40	98	90	267	5,5
	PN 63÷320 x 16÷40	98	115	292	7,0
	PN 400 x 16÷40	98	115	292	8,0
DN25 x DN25	PN 16÷40 x 16÷40	98	90	267	5,5
	PN 63÷320 x 16÷40	98	115	292	7,0
	PN 400 x 16÷40	98	115	292	8,0

# MATERIALS

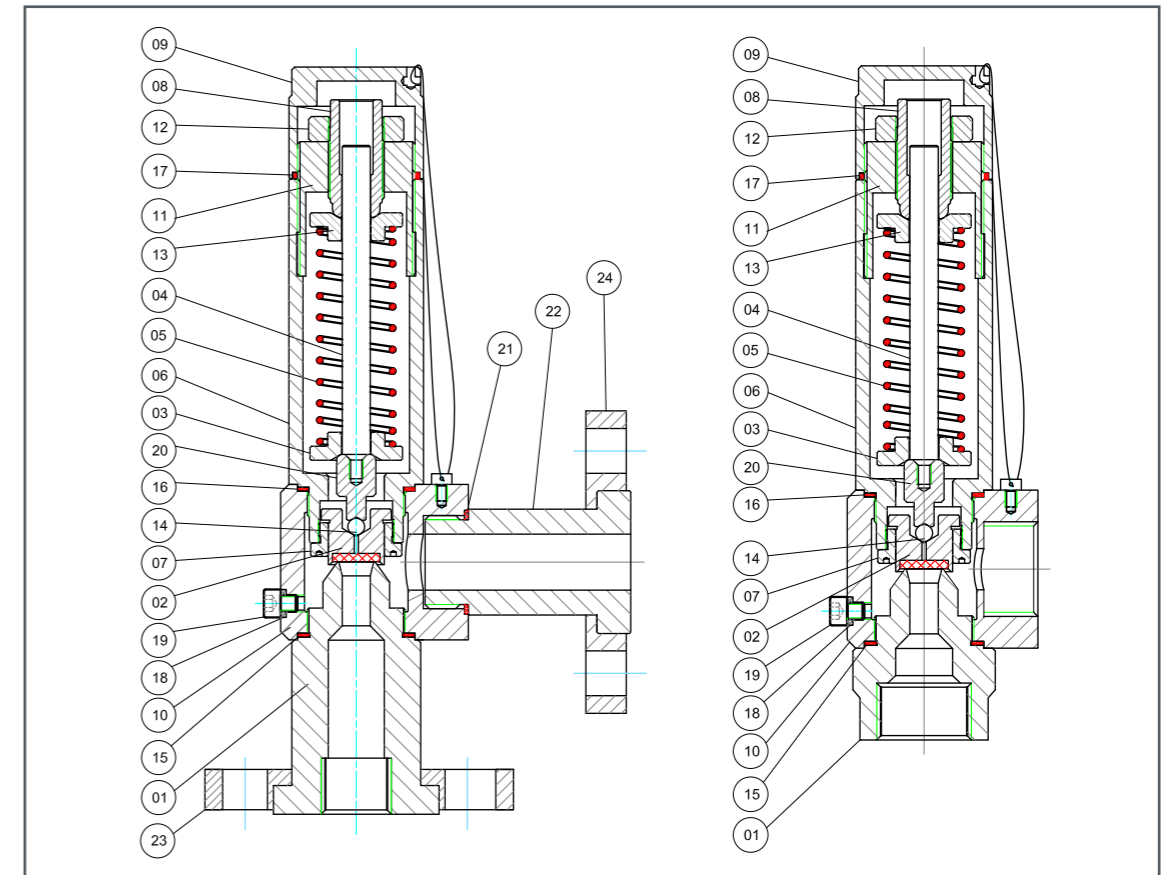

	PART NAME	MATERIAL CODE			
		011	072	012	095
01	NOZZLE	AISI 316L	AISI 316L	AISI 316L	AISI 316L
02	DISC	AISI 316L/PTFE	AISI 316L/PTFE	AISI 316L/PEEK	AISI 316L/PEEK
03	LOWER WASHER	AISI 316L	AISI 316L	AISI 316L	AISI 316L
04	STEM	AISI 316L	AISI 316L	AISI 316L	AISI 316L
05	SPRING	ALL. STEEL	ALL. STEEL	ALL. STEEL	ALL. STEEL
06	BONNET	AISI 316L	AISI 316L	AISI 316L	AISI 316L
07	GUIDE	AISI 316L	AISI 316L	AISI 316L	AISI 316L
08	SET SCREW	AISI 316L	AISI 316L	AISI 316L	AISI 316L
09	CAP	AISI 316L	AISI 316L	AISI 316L	AISI 316L
10	BODY	AISI 316L	AISI 316L	AISI 316L	AISI 316L
11	PRE SETT. SCREW	AISI 316L	AISI 316L	AISI 316L	AISI 316L
12	NUT	AISI 316L	AISI 316L	AISI 316L	AISI 316L
13	WASHER	AISI 316L	AISI 316L	AISI 316L	AISI 316L
14	BALL	AISI 316	AISI 316	AISI 316	AISI 316
15	GASKET	AISI 316L	AISI 316L	AISI 316L	AISI 316L
16	GASKET	PTFE	PTFE	PTFE	PTFE
17	GASKET	PTFE	PTFE	PTFE	PTFE
18	GASKET	PTFE	PTFE	PTFE	PTFE
19	DRAIN SCREW	AISI 316L	AISI 316L	AISI 316L	AISI 316L
20	PIN	AISI 316L	AISI 316L	AISI 316L	AISI 316L
21	GASKET	PTFE	PTFE	PTFE	PTFE
22	NIPPLE	AISI 316L	AISI 316	CARBON STEEL	AISI 316
23	FLANGE	CARBON STEEL	AISI 316L	CARBON STEEL	AISI 316
24	FLANGE	CARBON STEEL	AISI 316	CARBON STEEL	AISI 316

# TYPE "C"

## CHARACTERISTICS

Orifice $\varnothing$ / mm	8	10	14	20
Discharge area / cm <sup>2</sup>	0.504	0.785	1.54	3.14
Pressure range / bar	0.5 ÷ 415	0.5 ÷ 220	0.5 ÷ 90	0.5 ÷ 40

## INLET CONNECTIONS

Threaded	1" - 1 1/2"	NPT / GAS	NPT / GAS	NPT / GAS
Flanged / ASME	1" - 1 1/2"	150# ÷ 2500#	150# ÷ 2500#	150# ÷ 2500#
Flanged / DIN	DN25/DN40	PN16 ÷ PN400	PN16 ÷ PN400	PN16 ÷ PN400

## OUTLET CONNECTIONS

Threaded	1 1/2"	NPT / GAS	NPT / GAS	NPT / GAS
Flanged / ASME	1 1/2"	150# ÷ 600#	150# ÷ 600#	150# ÷ 600#
Flanged / DIN	DN40	PN16 ÷ PN40	PN16 ÷ PN40	PN16 ÷ PN40

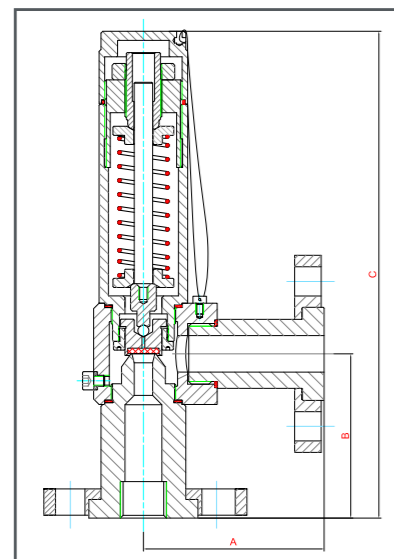
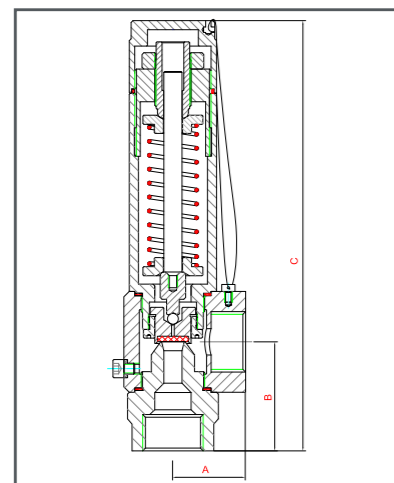

CONNECTIONS	THREADED	A	B	C	WEIGHT
Type		mm	mm	mm	kg
1" x 1 1/2"	NPT-F / GAS-F	45	70	250	4,5
1 1/2" x 1 1/2"	NPT-F / GAS-F	45	70	250	4,5

CONNECTIONS	FLANGED	A	B	C	WEIGHT
Typ		m	m	m	kg
1 x 1 1/2"	ASME 150÷600 x 150÷600	115	115	295	8
	ASME 900÷1500 x 150÷600	115	115	295	9,5
	ASME 2500 x 150÷600	130	130	310	10
1 1/2" x 1 1/2"	ASME 150÷600 x 150÷600	115	115	295	8
	ASME 900÷1500 x 150÷600	130	130	310	9,5
	ASME 2500 x 150÷600	130	130	310	10
DN25 x DN40	PN 16÷40 x 16÷40	115	115	295	8
	PN 63÷320 x 16÷40	115	115	295	9,5
	PN 400 x 16÷40	130	130	310	10
DN40 x DN40	PN 16÷40 x PN16÷40	115	115	295	8
	PN 63÷320 x PN16÷40	130	130	310	9,5
	PN 400 x PN16÷40	130	130	310	10

## MATERIALS

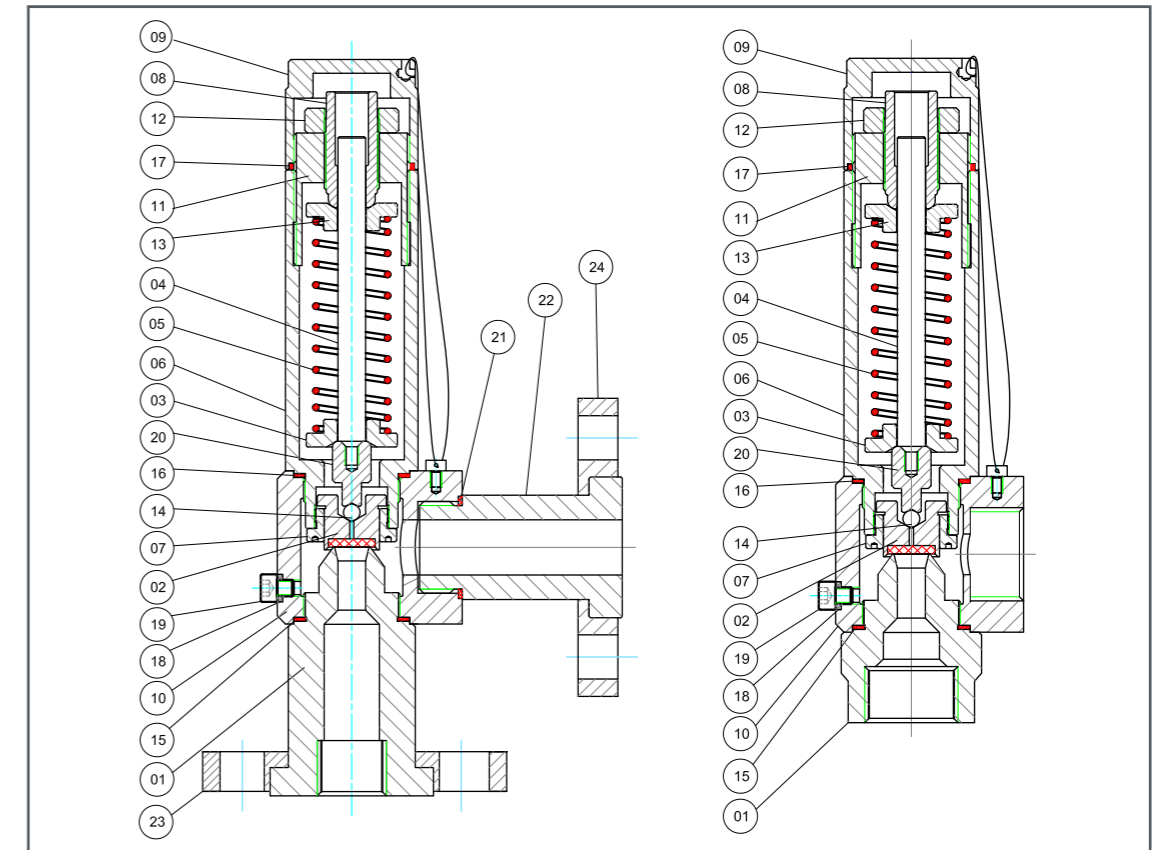

PART NAME	MATERIAL CODE			
	011	072	012	095
01 NOZZLE	AISI 316L	AISI 316L	AISI 316L	AISI 316L
02 DISC	AISI 316L/PTFE	AISI 316L/PTFE	AISI 316L/PEEK	AISI 316L/PEEK
03 LOWER WASHER	AISI 316L	AISI 316L	AISI 316L	AISI 316L
04 STEM	AISI 316L	AISI 316L	AISI 316L	AISI 316L
05 SPRING	ALL. STEEL	ALL. STEEL	ALL. STEEL	ALL. STEEL
06 BONNET	AISI 316L	AISI 316L	AISI 316L	AISI 316L
07 GUIDE	AISI 316L	AISI 316L	AISI 316L	AISI 316L
08 SET SCREW	AISI 316L	AISI 316L	AISI 316L	AISI 316L
09 CAP	AISI 316L	AISI 316L	AISI 316L	AISI 316L
10 BODY	AISI 316L	AISI 316L	AISI 316L	AISI 316L
11 PRE SETT. SCREW	AISI 316L	AISI 316L	AISI 316L	AISI 316L
12 NUT	AISI 316L	AISI 316L	AISI 316L	AISI 316L
13 WASHER	AISI 316L	AISI 316L	AISI 316L	AISI 316L
14 BALL	AISI 316	AISI 316	AISI 316	AISI 316
15 GASKET	AISI 316L	AISI 316L	AISI 316L	AISI 316L
16 GASKET	PTFE	PTFE	PTFE	PTFE
17 GASKET	PTFE	PTFE	PTFE	PTFE
18 GASKET	PTFE	PTFE	PTFE	PTFE
19 DRAIN SCREW	AISI 316L	AISI 316L	AISI 316L	AISI 316L
20 PIN	AISI 316L	AISI 316L	AISI 316L	AISI 316L
21 GASKET	PTFE	PTFE	PTFE	PTFE
22 NIPPLE	AISI 316L	AISI 316	CARBON STEEL	AISI 316
23 FLANGE	CARBON STEEL	AISI 316L	CARBON STEEL	AISI 316
24 FLANGE	CARBON STEEL	AISI 316	CARBON STEEL	AISI 316

# TYPE "D"

## CHARACTERISTICS

Orifice $\varnothing$ / mm	14	20	25	30
Discharge area / cm <sup>2</sup>	1.54	3.14	4.91	7.068
Pressure range / bar	0.5 ÷ 220	0.5 ÷ 48	0.5 ÷ 48	0.5 ÷ 48

## INLET CONNECTIONS

Threaded	1 1/2" - 2"	NPT / GAS	
Flanged / ASME	1 1/2" - 2"	150# ÷ 2500#	RF / RTJ
Flanged / DIN	DN40/DN50	PN16 ÷ PN400	

## OUTLET CONNECTIONS

Threaded	2"	NPT / GAS	
Flanged / ASME	2"	150# ÷ 600#	RF
Flanged / DIN	DN50	PN16 ÷ PN40	

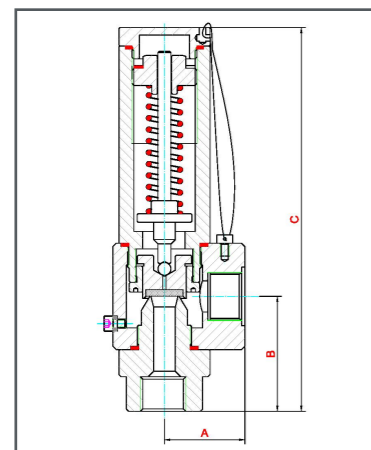

CONNECTIONS	THREADED	A	B	C	WEIGHT
Type		mm	mm	mm	kg
1 1/2" x 2"	NPT-F / GAS-F	70	85	275	7,5
2" x 2"	NPT-F / GAS-F	70	85	275	7,5

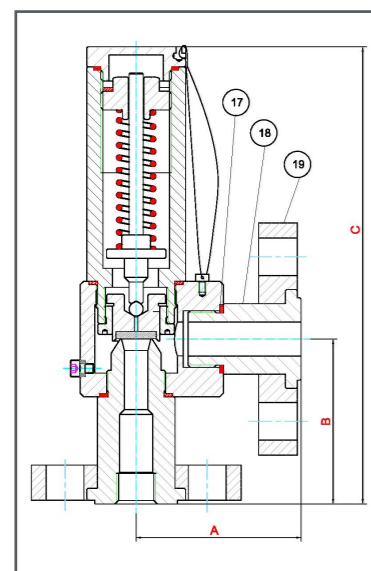

CONNECTIONS	FLANGED	A	B	C	WEIGHT
Type		mm	mm	mm	kg
1 1/2" x 2"	ASME 150÷600 x 150÷600	120	115	305	10
	ASME 900÷1500 x 150÷600	150	135	325	22
	ASME 2500 x 150÷600	150	150	340	27
2" x 2"	ASME 150÷600 x 150÷600	115	115	305	19
	ASME 900÷1500 x 150÷600	150	140	325	23
	ASME 2500 x 150÷600	150	150	340	28
DN40 x DN50	PN 16÷40 x 16÷40	120	120	310	18
	PN 63÷320 x 16÷40	150	140	325	22
	PN 400 x 16÷40	150	150	340	27
DN50 x DN50	PN 16÷40 x 16÷40	120	120	310	19
	PN 63÷320 x 16÷40	150	140	325	23
	PN 400 x 16÷40	150	150	340	28

## MATERIALS

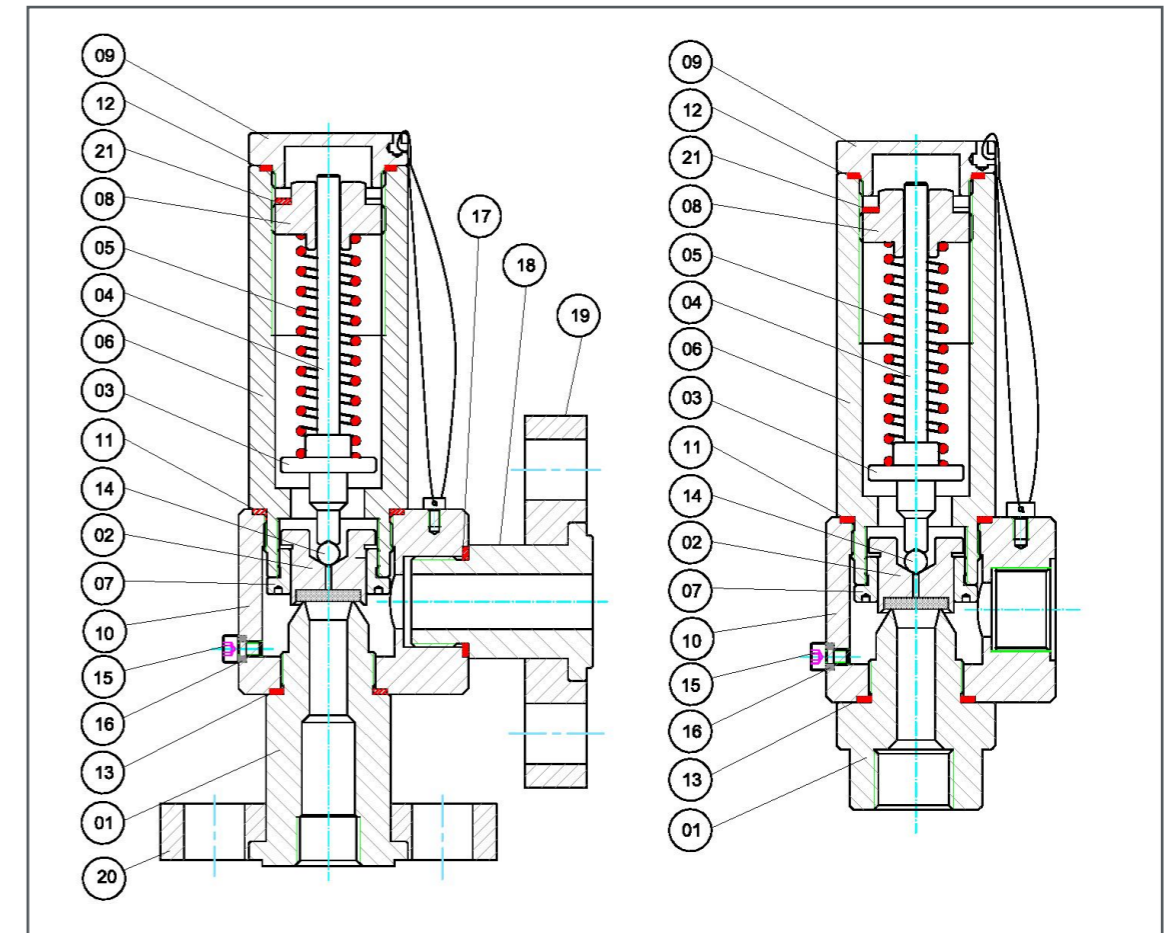

PART NAME		MATERIAL CODE			
		011	072	012	095
01	NOZZLE	AISI 316L	AISI 316L	AISI 316L	AISI 316L
02	DISC	AISI 316L/PTFE	AISI 316L/PTFE	AISI 316L/PEEK	AISI 316L/PEEK
03	LOWER WASHER	AISI 316L	AISI 316L	AISI 316L	AISI 316L
04	STEM	AISI 316L	AISI 316L	AISI 316L	AISI 316L
05	SPRING	ALL. STEEL	ALL. STEEL	ALL. STEEL	ALL. STEEL
06	BONNET	AISI 316L	AISI 316L	AISI 316L	AISI 316L
07	GUIDE	AISI 316L	AISI 316L	AISI 316L	AISI 316L
08	SET SCREW	AISI 316L	AISI 316L	AISI 316L	AISI 316L
09	CAP	AISI 316L	AISI 316L	AISI 316L	AISI 316L
10	BODY	AISI 316L	AISI 316L	AISI 316L	AISI 316L
11	GASKET	PTFE	PTFE	PTFE	PTFE
12	GASKET	PTFE	PTFE	PTFE	PTFE
13	GASKET	PTFE	PTFE	PTFE	PTFE
14	BALL	AISI 316	AISI 316	AISI 316	AISI 316
15	SCREW	AISI 316L	AISI 316L	AISI 316L	AISI 316L
16	GASKET	PTFE	PTFE	PTFE	PTFE
17	GASKET	PTFE	PTFE	PTFE	PTFE
18	NIPPLE	AISI 316L	AISI 316L	AISI 316L	AISI 316L
19	OUTLET FLANGE	CARBON STEEL	AISI 316	CARBON STEEL	AISI 316
20	INLET FLANGE	CARBON STEEL	AISI 316	CARBON STEEL	AISI 316
21	SEEGER	AISI 316L	AISI 316L	AISI 316L	AISI 316L

# TYPE "E"

## CHARACTERISTICS

Orifice $\varnothing$ / mm	10		
Discharge area / cm <sup>2</sup>	0.785		
Pressure range / bar	0.5 ÷ 40		

## INLET CONNECTIONS

Threaded	3/8" - 1/2"	NPT / GAS	
----------	-------------	-----------	--

## OUTLET CONNECTIONS

Threaded	1/2"	NPT / GAS	
----------	------	-----------	--

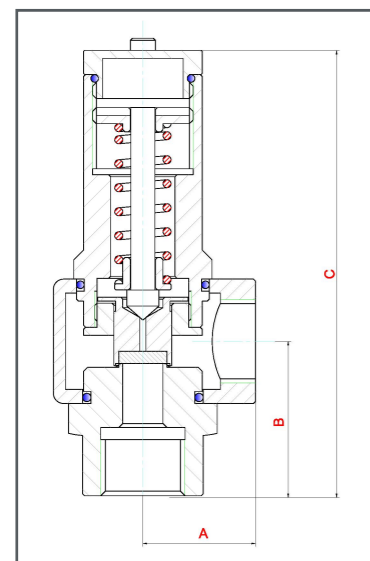

CONNECTIONS	THREADED	A	B	C	WEIGHT
Type		mm	mm	mm	kg
3/8" x 1/2"	GAS-F-M NPT-F-M	28	38,5	121	0,7
1/2" x 1/2"	GAS-F-M NPT-F-M	28	38,5	121	0,7

## MATERIALS

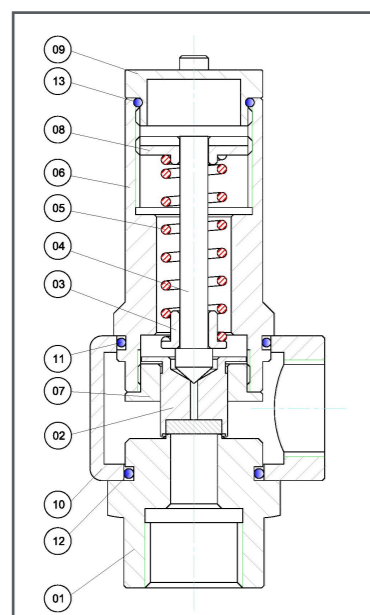

PART NAME	MATERIAL CODE	094	003	052
01	NOZZLE	BRONZE	BRASS	AISI 316L
02	DISC	BRONZE/PTFE	BRASS/PTFE	AISI 316L/PTFE
03	LOW. WASHER	BRASS	BRASS	BRASS
04	STEM	BRASS	BRASS	BRASS
05	SPRING	AISI 316	AISI 316	AISI 316
06	BONNET	BRASS	BRASS	BRASS
07	GUIDE	BRASS	BRASS	BRASS
08	SET SCREW	BRASS	BRASS	BRASS
09	CAP	BRASS	BRASS	BRASS
10	BODY	BRASS	BRASS	BRASS
11	GASKET	SILICON	VITON	VITON
12	GASKET	SILICON	VITON	VITON

# TYPE "F"

## CHARACTERISTICS

Orifice $\varnothing$ / mm	4	6	8
Discharge area / cm <sup>2</sup>	0.12	0.28	0.502
Pressure range / bar	10 ÷ 1200	0.5 ÷ 790	0.5 ÷ 150

## INLET CONNECTIONS

Threaded	1/4" - 1/2"	NPT / GAS	
----------	-------------	-----------	--

## OUTLET CONNECTIONS

Threaded	1/4" - 1/2"	NPT / GAS	
----------	-------------	-----------	--

CONNECTIONS	THREADED	A	B	C	WEIGHT
Type		mm	mm	mm	kg
1/4" x 1/4"	GAS-F/ NPT-F	26	30	100	1,0
1/2" x 1/2"	GAS-F/ NPT-F	33,5	43,5	138	1,5

## MATERIALS

PART NAME	MATERIAL CODE	011	012
01	NOZZLE	AISI 316L	AISI 316L
02	DISC	AISI 316L/PTFE	AISI 316L/PEEK
03	LOW. WASHER	AISI 316L	AISI 316L
04	STEM	AISI 316L	AISI 316L
05	SPRING	ALL. STEEL	ALL. STEEL
06	BONNET	AISI 316L	AISI 316L
07	GUIDE	AISI 316L	AISI 316L
08	SET SCREW	AISI 316L	AISI 316L
09	CAP	AISI 316L	AISI 316L
10	BODY	AISI 316L	AISI 316L
11	GASKET	PTFE	PTFE
12	GASKET	PTFE	PTFE
13	GASKET	PTFE	PTFE
14	BALL	AISI 316	AISI 316
15	DRAIN SCREW	AISI 316L	AISI 316L
16	GASKET	PTFE	PTFE
17	SEEGER	AISI 316	AISI 316

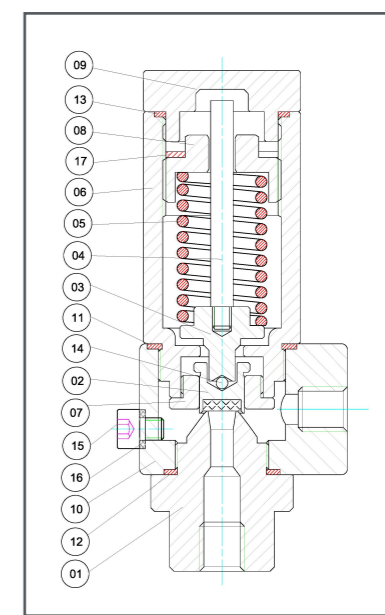
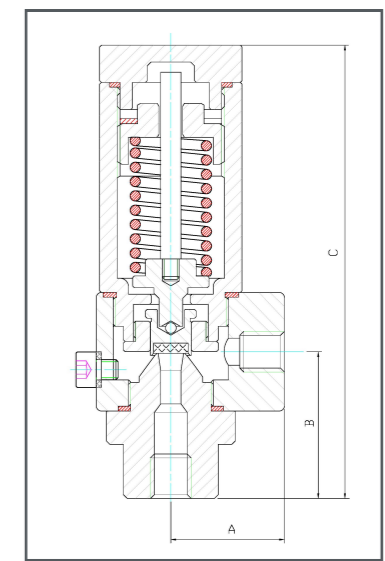

# GLV

## SERIES Plastic Version



### Relief Valves GLV-Series PLASTIC VERSION

#### Application

- Chemical plants
- Petrochemical plants
- Dosing systems
- Injections skids
- Metering pumps
- Water treatment and desalination plants

#### Materials

PVC, PVC-C, PP, PVDF, PTFE.

#### Design

- |                        |                                  |
|------------------------|----------------------------------|
| - Construction:        | Angle-type                       |
| - Seat sealing type:   | PTFE                             |
| - Connections:         | Screwed and flanged (ANSI / DIN) |
| - Connections types:   | GAS / BSPP                       |
| - Flange ratings:      | ASME 150 ÷ 300 / PN16 ÷ PN 40    |
| - Sizes:               | 1/2" ÷ 2" / DN 15 ÷ DN 50        |
| - Orifices:            | 10, 14, 20, 25, 30 mm            |
| - Characteristic:      | Full lift                        |
| - Overpressure:        | 10%                              |
| - Blowdown:            | 15%                              |
| - Discharge coeff. Kd: | 0.7                              |
| - Temperature range:   | - 20°C + 180°C                   |
| - Set pressure range:  | 0.5 ÷ 12 barg                    |
| - Design standard      | EN 4162-1                        |

#### Approvals

- CE marking according to 2014/68/EU
- 2014/34/EU (ATEX)
- EAC ( EurAsian Conformity mark (EAC, Russian: Евразийское соответствие)



# TYPE "A"

## CHARACTERISTICS

Orifice $\varnothing$ / mm	10		
Discharge area / cm <sup>2</sup>	0.785		
Pressure range / bar	0.5 ÷ 12		

## INLET CONNECTIONS

Threaded	1/2" - 3/4"	GAS	
Flanged / ASME	1/2" - 3/4"	150# ÷ 300#	RF / FF
Flanged / DIN	DN15 - DN20	PN16 ÷ PN40	

## OUTLET CONNECTIONS

Threaded	1/2" - 3/4"	GAS	
Flanged / ASME	1/2" - 3/4"	150# ÷ 300#	RF / FF
Flanged / DIN	DN15 - DN20	PN16 ÷ PN40	

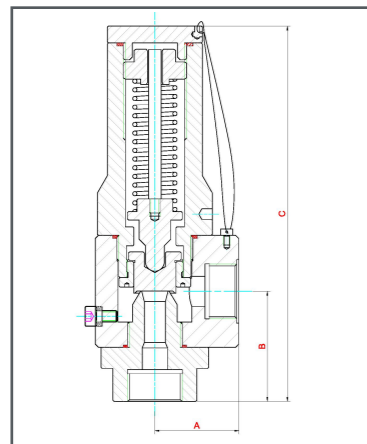

CONNECTIONS	THREADED	A	B	C	WEIGHT
Type		mm	mm	mm	kg
1/2" x 1/2"	GAS-F	40	52	182	1,5
3/4" x 3/4"	GAS-F	40	52	182	1,5

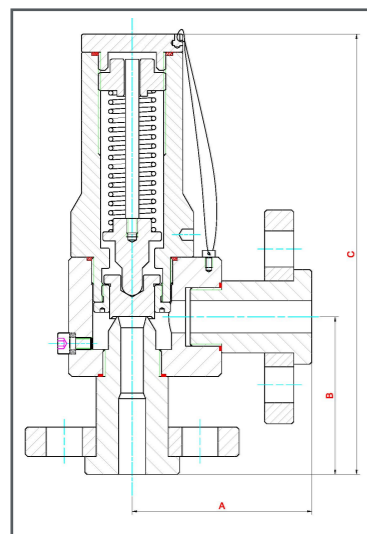

CONNECTIONS	FLANGED	A	B	C	WEIGHT
Type		mm	mm	mm	kg
1/2" x 1/2"	ASME 150÷300 x 150÷300	80	70	200	2,0
3/4" x 3/4"	ASME 150÷300 x 150÷300	80	80	220	2,5
DN15 x DN15	PN 16÷40 x 16÷40	80	70	200	2,0
DN20 x DN20	PN 16÷40 x 16÷40	80	80	220	2,5

# MATERIALS

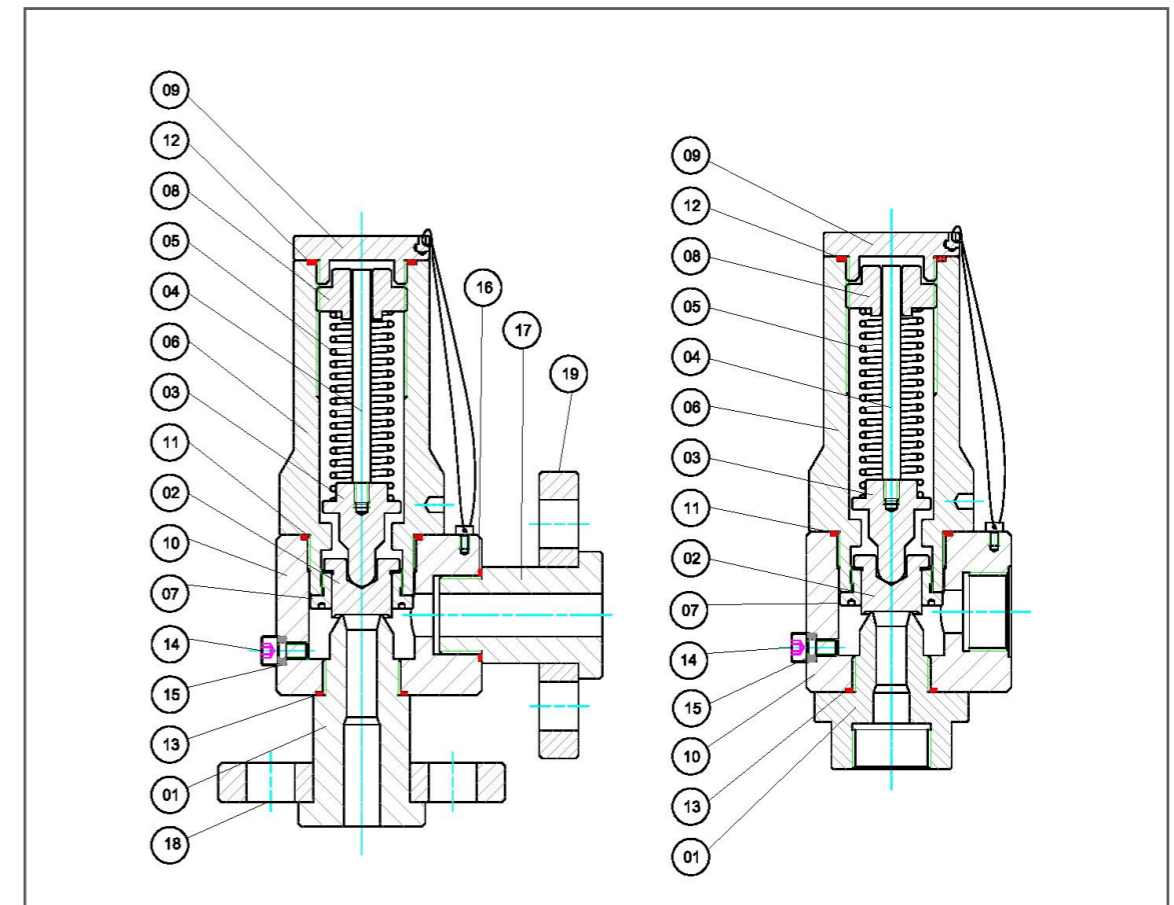

PART NAME		MATERIAL CODE			
		063	126	062	128
01	NOZZLE	PVC	PVC	PP	PP
02	DISC	PTFE	PTFE	PTFE	PTFE
03	LOWER WASHER	PVC	PVC	PP	PP
04	STEM	PVC	PVC	PP	PP
05	SPRING	ALL. STEEL	ALL. STEEL	ALL. STEEL	ALL. STEEL
06	BONNET	PVC	PVC	PP	PP
07	GUIDE	PVC	PVC	PP	PP
08	SET SCREW	PVC	PVC	PP	PP
09	CAP	PVC	PVC	PP	PP
10	BODY	PVC	PVC	PP	PP
11	GASKET	PTFE	PTFE	PTFE	PTFE
12	GASKET	PTFE	PTFE	PTFE	PTFE
13	GASKET	PTFE	PTFE	PTFE	PTFE
14	SCREW	PP	PP	PP	PP
15	GASKET	PTFE	PTFE	PTFE	PTFE
16	GASKET	PTFE	PTFE	PTFE	PTFE
17	NIPPLE	PP	PP	PP	PP
18	FLANGE	C. STEEL	PP LINED C.S.	C. STEEL	PP LINED C.S.
19	FLANGE	C. STEEL	PP LINED C.S.	C. STEEL	PP LINED C.S.

# TYPE "B"

## CHARACTERISTICS

Orifice $\varnothing$ / mm	10	14	
Discharge area / cm <sup>2</sup>	0.785	1.54	
Pressure range / bar	0.5 ÷ 12	0.5 ÷ 12	

## INLET CONNECTIONS

Threaded	1/2" - 3/4" - 1"	GAS	
Flanged / ASME	1/2" - 3/4" - 1"	150# ÷ 300#	RF / FF
Flanged / DIN	DN15 ÷ DN25	PN16 ÷ PN40	

## OUTLET CONNECTIONS

Threaded	1"	GAS	
Flanged / ASME	1"	150# ÷ 300#	RF / FF
Flanged / DIN	DN25	PN16 ÷ PN40	

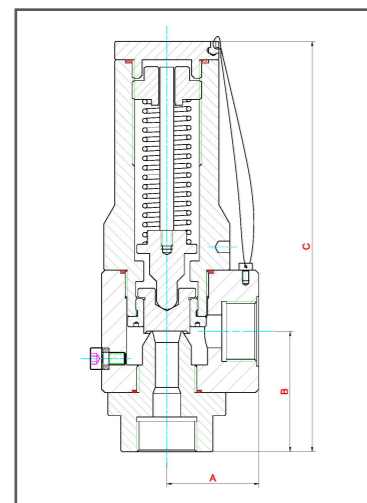

CONNECTIONS	THREADED	A	B	C	WEIGHT
Type		mm	mm	mm	kg
1/2" x 1"	GAS-F	47	70	222	2,0
3/4" x 1"	GAS-F	47	70	222	2,0
1" x 1"	GAS-F	47	70	222	2,0

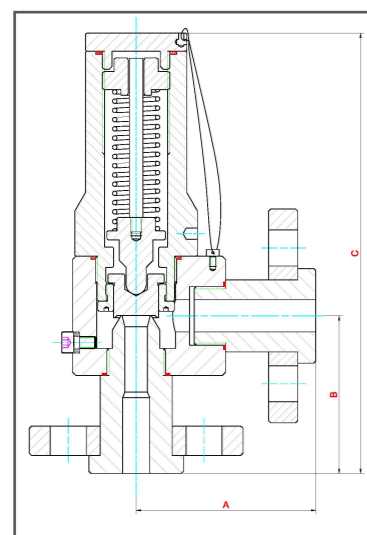

CONNECTIONS	FLANGED	A	B	C	WEIGHT
Type		mm	mm	mm	kg
1/2" x 1"	ASME 150÷300 x 150÷300	98	90	242	3,0
3/4" x 1"	ASME 150÷300 x 150÷300	98	90	242	3,0
1" x 1"	ASME 150÷300 x 150÷300	98	90	242	3,0
DN15 x DN25	PN 16÷40 x 16÷40	98	90	242	3,0
DN20 x DN25	PN 16÷40 x 16÷40	98	90	242	3,0
DN25 x DN25	PN 16÷40 x 16÷40	98	90	242	3,0

# MATERIALS

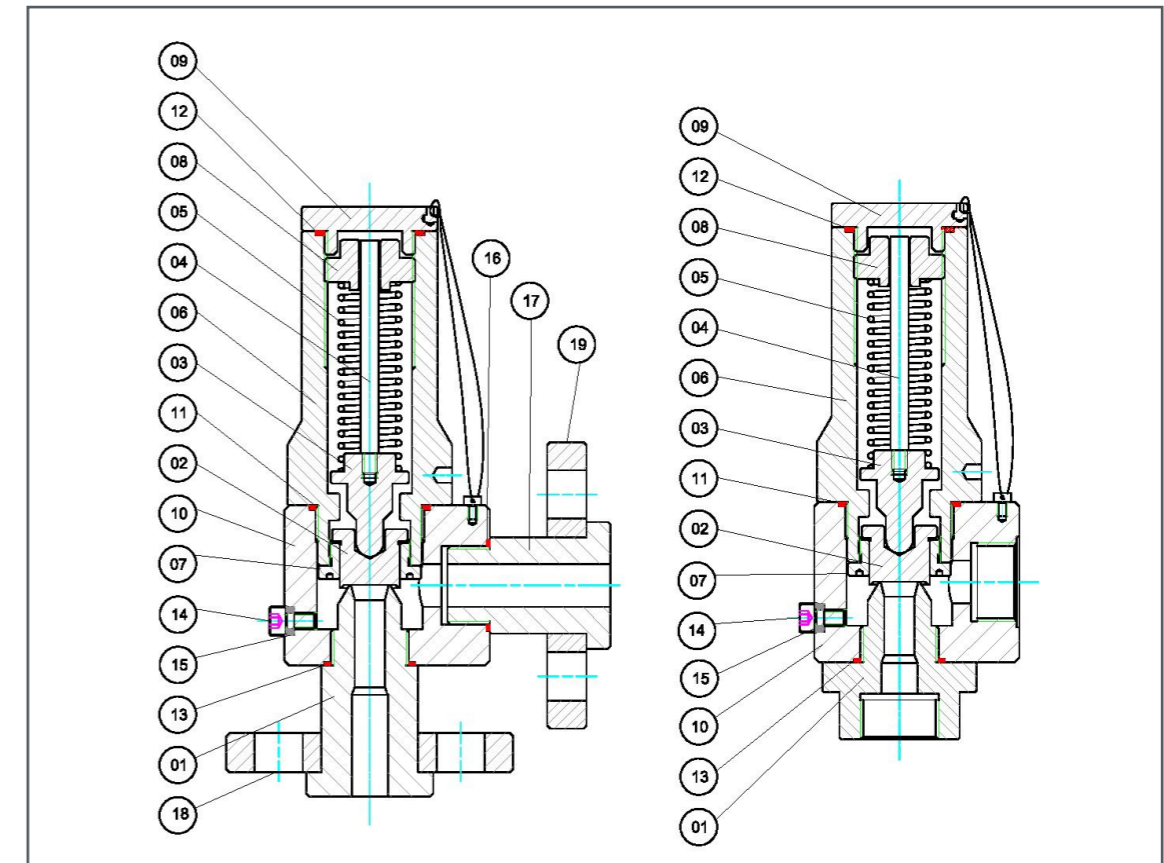

PART NAME		MATERIAL CODE			
		063	126	062	128
01	NOZZLE	PVC	PVC	PP	PP
02	DISC	PTFE	PTFE	PTFE	PTFE
03	LOWER WASHER	PVC	PVC	PP	PP
04	STEM	PVC	PVC	PP	PP
05	SPRING	ALL. STEEL	ALL. STEEL	ALL. STEEL	ALL. STEEL
06	BONNET	PVC	PVC	PP	PP
07	GUIDE	PVC	PVC	PP	PP
08	SET SCREW	PVC	PVC	PP	PP
09	CAP	PVC	PVC	PP	PP
10	BODY	PVC	PVC	PP	PP
11	GASKET	PTFE	PTFE	PTFE	PTFE
12	GASKET	PTFE	PTFE	PTFE	PTFE
13	GASKET	PTFE	PTFE	PTFE	PTFE
14	SCREW	PP	PP	PP	PP
15	GASKET	PTFE	PTFE	PTFE	PTFE
16	GASKET	PTFE	PTFE	PTFE	PTFE
17	NIPPLE	PP	PP	PP	PP
18	FLANGE	C. STEEL	PP LINED C.S.	C. STEEL	PP LINED C.S.
19	FLANGE	C. STEEL	PP LINED C.S.	C. STEEL	PP LINED C.S.

# TYPE "C"

## CHARACTERISTICS

Orifice $\varnothing$ / mm	14	20	
Discharge area / cm <sup>2</sup>	1.54	3.14	
Pressure range / bar	0.5 ÷ 12	0.5 ÷ 9	

## INLET CONNECTIONS

Threaded	1 1/2"	GAS / BSPP	
Flanged / ASME	1 1/2"	150# ÷ 2500#	RF / FF
Flanged / DIN	DN40	PN16 ÷ PN40	

## OUTLET CONNECTIONS

Threaded	1 1/2"	GAS / BSPP	
Flanged / ASME	1 1/2"	150# ÷ 300#	RF / FF
Flanged / DIN	DN40	PN16 ÷ PN40	

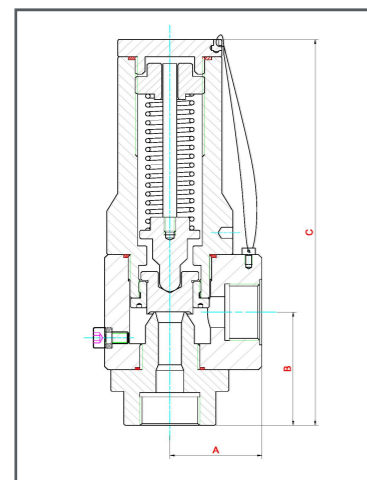

CONNECTIONS	THREADED	A	B	C	WEIGHT
Type		mm	mm	mm	kg
1" x 1 1/2"	GAS-F	65	75	230	4
1 1/2" x 1 1/2"	GAS-F	65	75	230	4

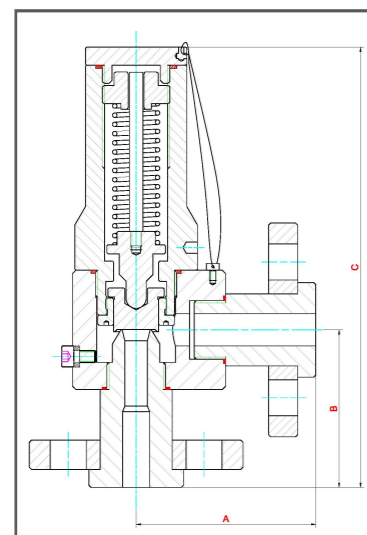

CONNECTIONS	FLANGED	A	B	C	WEIGHT
Type		mm	mm	mm	kg
1" x 1 1/2"	ASME 150÷300 x 150÷300	115	105	260	6
1 1/2" x 1 1/2"	ASME 150÷300 x 150÷300	115	105	260	6
DN25 x DN40	PN 16÷40 x 16÷40	115	105	260	6
DN40 x DN40	PN 16÷40 x 16÷40	115	105	260	6

# MATERIALS

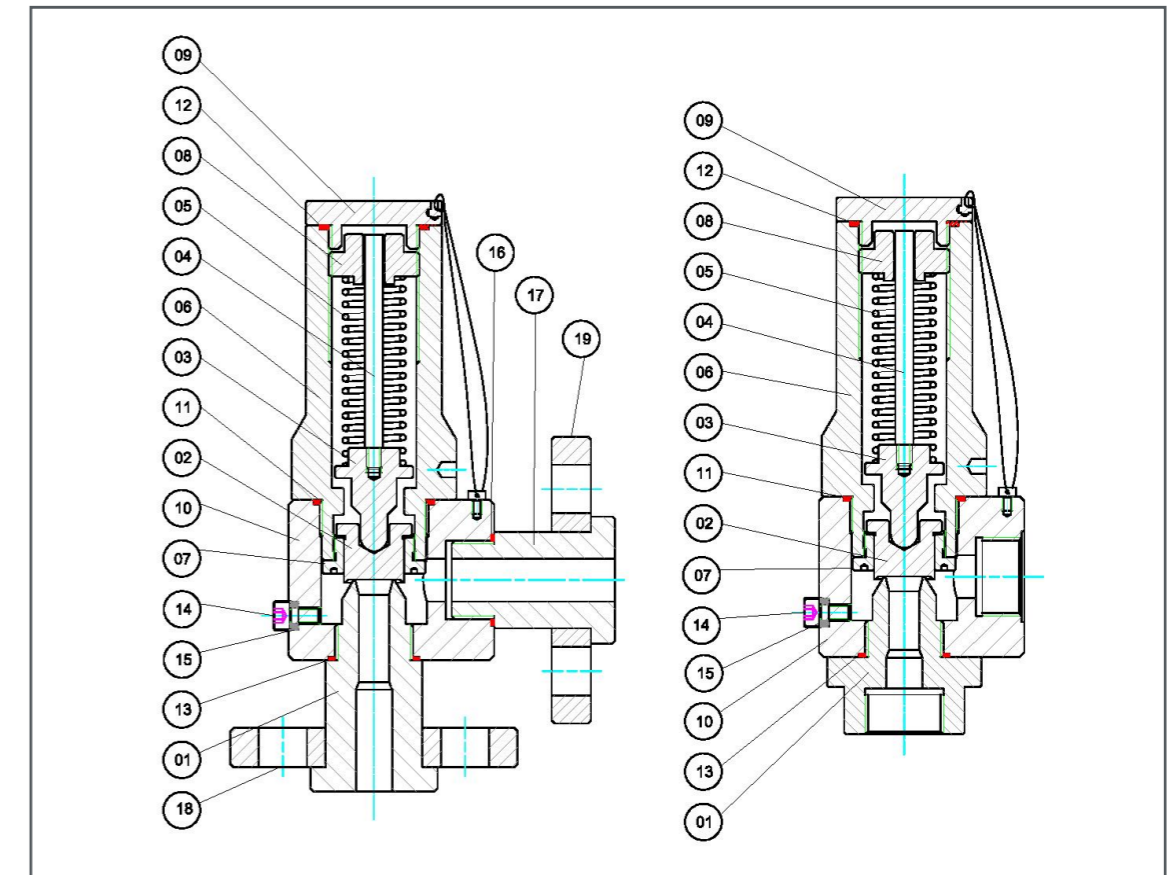

PART NAME		MATERIAL CODE			
		063	126	062	128
01	NOZZLE	PVC	PVC	PP	PP
02	DISC	PTFE	PTFE	PTFE	PTFE
03	LOWER WASHER	PVC	PVC	PP	PP
04	STEM	PVC	PVC	PP	PP
05	SPRING	ALL. STEEL	ALL. STEEL	ALL. STEEL	ALL. STEEL
06	BONNET	PVC	PVC	PP	PP
07	GUIDE	PVC	PVC	PP	PP
08	SET SCREW	PVC	PVC	PP	PP
09	CAP	PVC	PVC	PP	PP
10	BODY	PVC	PVC	PP	PP
11	GASKET	PTFE	PTFE	PTFE	PTFE
12	GASKET	PTFE	PTFE	PTFE	PTFE
13	GASKET	PTFE	PTFE	PTFE	PTFE
14	SCREW	PP	PP	PP	PP
15	GASKET	PTFE	PTFE	PTFE	PTFE
16	GASKET	PTFE	PTFE	PTFE	PTFE
17	NIPPLE	PP	PP	PP	PP
18	FLANGE	C. STEEL	PP LINED C.S.	C. STEEL	PP LINED C.S.
19	FLANGE	C. STEEL	PP LINED C.S.	C. STEEL	PP LINED C.S.

# TYPE "D"

## CHARACTERISTICS

Orifice $\varnothing$ / mm	20	25	30
Discharge area / cm <sup>2</sup>	3.14	4.91	7.068
Pressure range / bar	0.5 ÷ 9	0.5 ÷ 8	0.5 ÷ 8

## INLET CONNECTIONS

Threaded	1 1/2" - 2"	GAS / BSPP	
Flanged / ASME	1 1/2" - 2"	150# ÷ 300#	RF / FF
Flanged / DIN	DN40/DN50	PN16 ÷ PN40	

## OUTLET CONNECTIONS

Threaded	2"	GAS / BSPP	
Flanged / ASME	2"	150# ÷ 300#	RF / FF
Flanged / DIN	DN50	PN16 ÷ PN40	

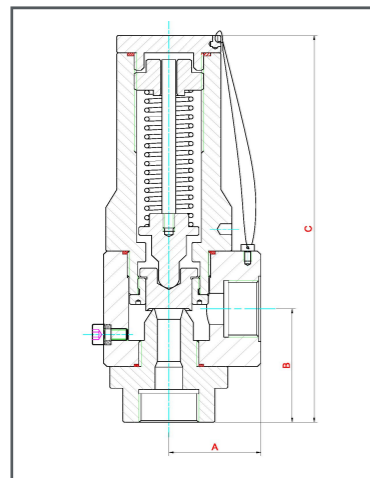

CONNECTIONS	THREADED	A	B	C	WEIGHT
Type		mm	mm	mm	kg
1 1/2" x 2"	GAS-F	70	85	275	5
2" x 2"	GAS-F	70	85	275	5

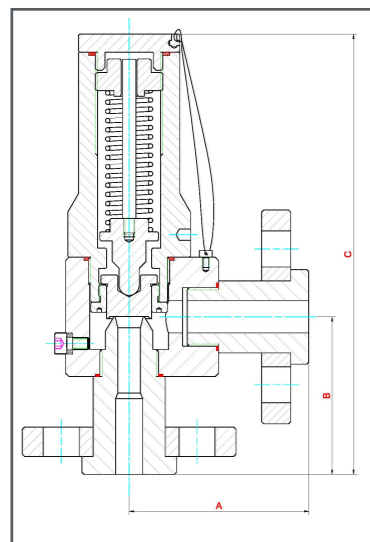

CONNECTIONS	FLANGED	A	B	C	WEIGHT
Type		mm	mm	mm	kg
1 1/2" x 2"	ASME 150÷300 x 150÷300	115	105	300	7
2" x 2"	ASME 150÷300 x 150÷300	115	115	310	7
DN40 x DN50	PN 16÷40 x 16÷40	115	105	300	7
DN50 x DN50	PN 16÷40 x 16÷40	115	115	310	7

# MATERIALS

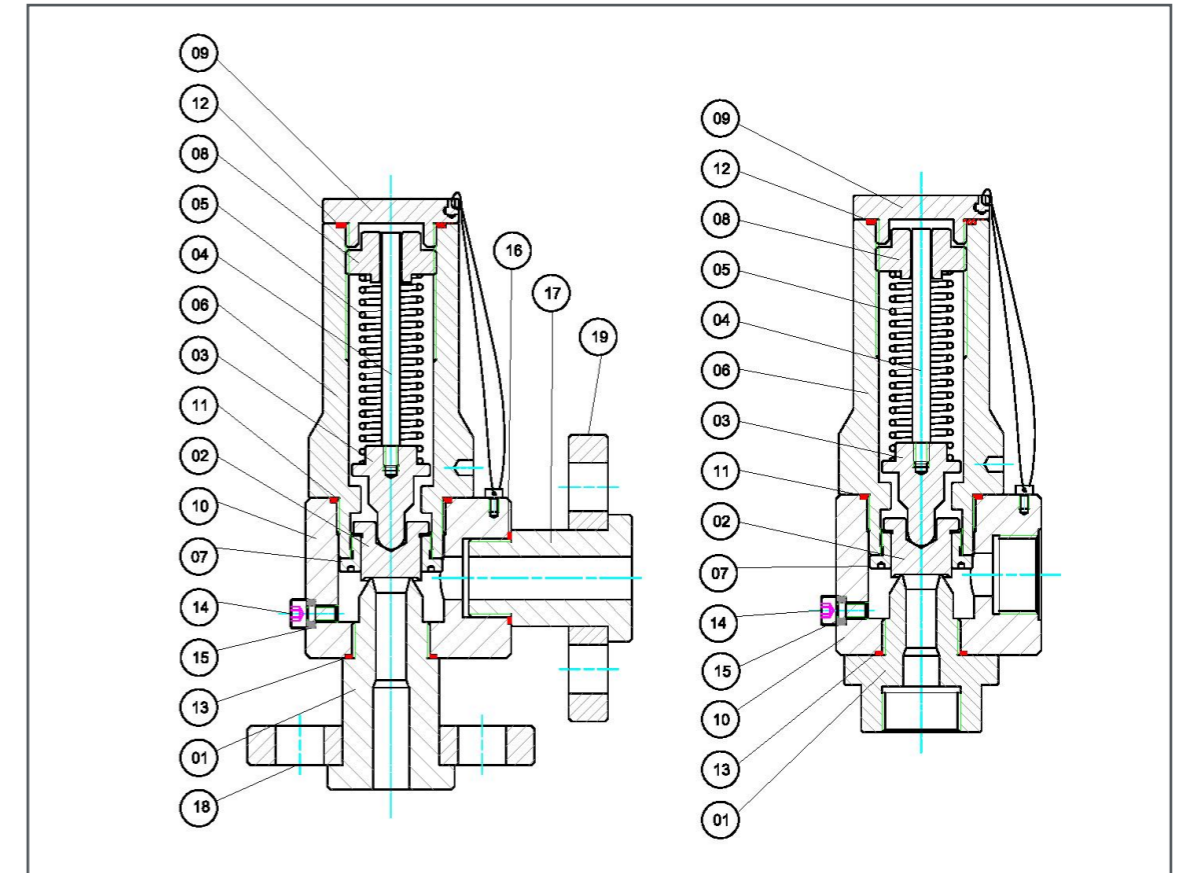

PART NAME		MATERIAL CODE			
		063	126	062	128
01	NOZZLE	PVC	PVC	PP	PP
02	DISC	PTFE	PTFE	PTFE	PTFE
03	LOWER WASHER	PVC	PVC	PP	PP
04	STEM	PVC	PVC	PP	PP
05	SPRING	ALL. STEEL	ALL. STEEL	ALL. STEEL	ALL. STEEL
06	BONNET	PVC	PVC	PP	PP
07	GUIDE	PVC	PVC	PP	PP
08	SET SCREW	PVC	PVC	PP	PP
09	CAP	PVC	PVC	PP	PP
10	BODY	PVC	PVC	PP	PP
11	GASKET	PTFE	PTFE	PTFE	PTFE
12	GASKET	PTFE	PTFE	PTFE	PTFE
13	GASKET	PTFE	PTFE	PTFE	PTFE
14	SCREW	PP	PP	PP	PP
15	GASKET	PTFE	PTFE	PTFE	PTFE
16	GASKET	PTFE	PTFE	PTFE	PTFE
17	NIPPLE	PP	PP	PP	PP
18	FLANGE	C. STEEL	PP LINED C.S.	C. STEEL	PP LINED C.S.
19	FLANGE	C. STEEL	PP LINED C.S.	C. STEEL	PP LINED C.S.

## How to reach our Company

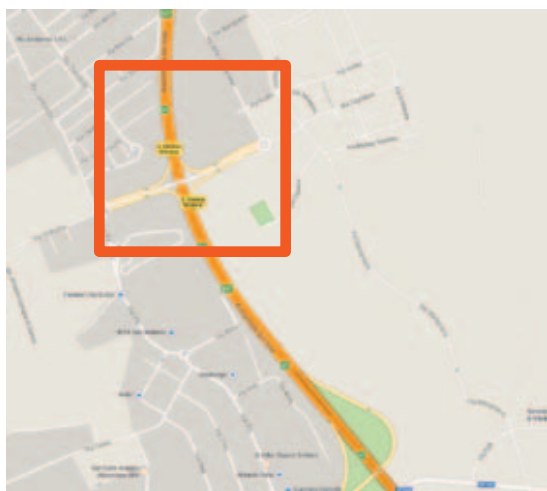

1. **Highway A1** (tangenziale Ovest) exit San Giuliano Milanese
2. proceed to **Via della Liberazione**



LA CENTRALE COMUNICATI



Management System  
ISO 9001:2015

www.tuv.com  
ID: 9105022030

